



KONICA MINOLTA

# bizhub C3110

- ✓ Colour A4 multifunctional
- ✓ Up to 31 pages per minute

## Functionality



- Colour
- Black & white

Copying



- Colour
- Black & white
- PCL/PS
- Local/Network
- USB

Printing



- Colour
- Black & white
- Scan-to-eMail
- Scan-to-SMB
- Scan-to-FTP
- Scan-to-HDD
- Scan-to-USB
- Scan-to-DPWS
- TWAIN Network

Scanning



- Super G3 Fax
- PC-Fax

Faxing



Giving Shape to Ideas

## Technology

Emperon™ – print controller	Easily compatible with different users and IT environments through Konica Minolta's unified print technology	✓
Simitri® HD – polymerised toner	Delivers high print quality and yet ensures reduced print spending as well as lower environmental impact	✓
OpenAPI – solution platform	Server-based applications provide efficient workflows for the entire MFP fleet	✗
i-Option – special feature	Offers extended scope and advanced MFP functionality in line with individual requirements	✓
CSRC – remote service	Keeps productivity up with online monitoring of devices and consumables through the Konica Minolta service	✓
IWS – panel customisation	Improved user-device interaction and enhanced productivity through full MFP panel customisation	✗

## Option diagram

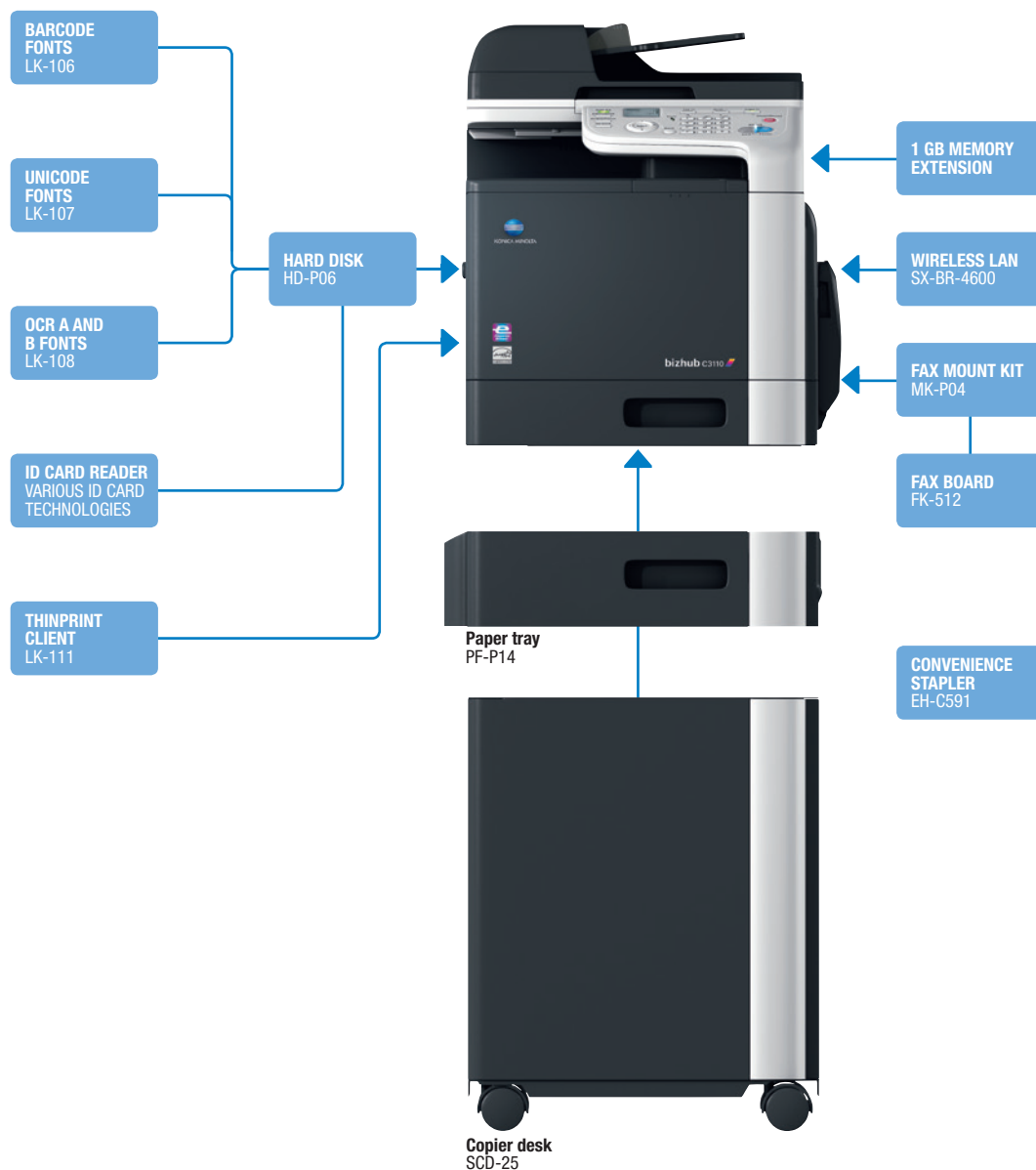

## Finishing functionality



Duplex

## Descriptions

<b>bizhub C3110</b>	A4 multifunctional with 31 ppm b/w and colour. Standard Emperon™ print controller with PCL, PostScript and optional XPS support. Paper capacity of 250 sheets and 100-sheet manual bypass. Automatic duplex document feeder and duplex unit standard. 1 GB memory and Gigabit Ethernet standard.
<b>PF-P14 Paper tray</b>	A4; 500 sheets; up to 90 gsm
<b>SCD-25 Copier desk</b>	Ensures economic height and provides storage space for print media, etc.
<b>HD-P06 Hard disk</b>	320 GB hard disk <sup>1</sup>

<b>1 GB Memory extension</b>	For faster processing
<b>FK-512 Fax board</b>	Super G3 fax, digital fax functionality
<b>MK-P04 Fax mount kit</b>	Installation kit for fax board
<b>ID card reader</b>	Various ID card technologies <sup>1</sup>
<b>LK-106 Barcode fonts</b>	Supports native barcode printing <sup>1</sup>
<b>LK-107 Unicode fonts</b>	Supports native Unicode printing <sup>1</sup>
<b>LK-108 OCR A and B fonts</b>	Supports native OCR A and B font printing <sup>1</sup>
<b>LK-111 ThinPrint® Client</b>	Print data compression for reduced network impact
<b>SX-BR-4600 Wireless LAN</b>	Wireless LAN to network connector
<b>EH-C591 Convenience stapler</b>	Convenient stapling of up to 50 prints per set

## Technical specifications

### SYSTEM SPECIFICATIONS

<b>System memory</b>	1 GB (standard) 2 GB (optional)
<b>System hard disk</b>	320 GB (optional)
<b>Interface</b>	10-Base-T/100-Base-TX/1,000-Base-T Ethernet; USB 2.0
<b>Network protocols</b>	TCP/IP (IPv4 / IPv6); SMB; LPD; IPP; SNMP; HTTP; HTTPS
<b>Frame types</b>	Ethernet 802.2; Ethernet 802.3; Ethernet II; Ethernet SNAP
<b>Automatic document feeder</b>	Up to 50 originals; A6–A4; 50-110 gsm
<b>Printable paper size</b>	A6–A4; customised paper sizes
<b>Printable paper weight</b>	60–210 gsm
<b>Paper input capacity</b>	Standard: 350 sheets Max.: 850 sheets
<b>Tray 1</b>	250 sheets; A6–A4; 60–210 gsm
<b>Tray 2 (optional)</b>	500 sheets; A4; 60–90 gsm
<b>Manual bypass</b>	100 sheets; A6–A4; custom sizes 60–210 gsm
<b>Automatic duplexing</b>	A4; 60–210 gsm
<b>Output capacity</b>	Max.: 150 sheets
<b>Copy/print volume (monthly)</b>	Rec.: 6,500 pages Max. <sup>2</sup> : 120,000 pages
<b>Toner lifetime</b>	Black 5,000 pages; CMY 5,000 pages
<b>Imaging unit lifetime</b>	Black 25,000 pages; CMY 25,000 pages
<b>Power consumption</b>	220–240 V / 50/60 Hz Less than 1.2 kW (system)
<b>System dimensions (W x D x H)</b>	447 x 544 x 500 mm
<b>System weight</b>	Approx. 30 kg

### COPIER SPECIFICATIONS

<b>Copying process</b>	Electrostatic laser copy, tandem, indirect
<b>Toner system</b>	Simitri® HD polymerised toner
<b>Copy/print speed A4 (mono/colour)</b>	Up to 31 ppm
<b>Autoduplex speed A4 (mono/colour)</b>	Up to 31 ppm
<b>1st print out time (mono/colour)</b>	13 sec. 17 sec.
<b>Warm-up time</b>	Approx. 38 sec. <sup>3</sup>
<b>Copy resolution</b>	600 x 600 dpi
<b>Gradation</b>	256 gradations
<b>Multi-copy</b>	1–99
<b>Original format</b>	A6–A4
<b>Magnification</b>	25–400 % in 1 % steps; auto-zooming
<b>Copy functions</b>	Duplex copy; ID card copy; 2-in-1; 4-in-1; poster; density adjustments

### PRINTER SPECIFICATIONS

<b>Print resolution</b>	1,200 x 1,200 dpi
<b>Page description language</b>	PCL 5e/c PostScript 3 (CPSI 3016) XPS <sup>1</sup>
<b>Operating systems</b>	Windows VISTA (32/64) Windows 7 (32/64) Windows 8 (32/64) Windows Server 2003/2008 (32/64) Windows Server 2012 Windows Server 2012 R2 Macintosh OS X 10.x Linux Citrix
<b>Printer fonts</b>	80 PCL Latin 137 PostScript 3 Latin
<b>Print functions</b>	Direct print <sup>1</sup> of TIFF, XPS <sup>1</sup> , PDF <sup>1</sup> (v1.7) and JPEG; XPS <sup>1</sup> and OOXML (DOCX, XLSX, PPTX); secure print <sup>1</sup> ; combination; n-up; poster; overlay; watermark
<b>Mobile Printing</b>	AirPrint (iOS), Mopria (Android), Konica Minolta Print Service (Android), PageScope Mobile (iOS & Android)

### SCANNER SPECIFICATIONS

<b>Scan speed (mono/colour)</b>	Up to 30 ipm
<b>Scan resolution</b>	Max.: 600 x 600 dpi
<b>Scan modes</b>	Scan-to-eMail (Scan-to-Me) Scan-to-SMB (Scan-to-Home) Scan-to-FTP Scan-to-USB Scan-to-HDD <sup>1</sup> Scan-to-DPWS Network TWAIN scan
<b>File formats</b>	TIFF; PDF; Compact PDF; JPEG; XPS <sup>1</sup>
<b>Scan destinations</b>	250 (shared with fax); LDAP support

### FAX SPECIFICATIONS

<b>Fax standard</b>	Super G3 (optional)
<b>Fax transmission</b>	Analogue PC-Fax
<b>Fax resolution</b>	Max.: 600 x 600 dpi (ultra-fine)
<b>Fax compression</b>	MH; MR; MMR; JBIG
<b>Fax modem</b>	Up to 33.6 Kbps
<b>Fax destinations</b>	250 (shared with scan); LDAP support
<b>Fax functions</b>	Polling; time shift; PC-Fax

**SYSTEM FEATURES**

<b>Security</b>	ISO 15408 EAL3 (in evaluation) <sup>1</sup> ; IP filtering and port blocking; SSL2 <sup>2</sup> ; SSL3 <sup>1</sup> and TLS1.0 network communication <sup>1</sup> ; IPsec support <sup>1</sup> ; IEEE 802.1x support <sup>1</sup> ; user authentication <sup>1</sup> ; secure print <sup>1</sup> ; hard disk overwrite (8 standard types) <sup>1</sup> ; hard disk data encryption <sup>1</sup>
<b>Software</b>	PageScope Net Care Device Manager PageScope WebConnection PageScope Data Administrator PageScope Direct Print

<sup>1</sup> 1 HD-P06 optional hard disk enables secure printing, proof-then-print, print & hold, job storing, XPS emulation, i-Option support and ID card reader support

<sup>2</sup> If the maximum volume is reached within a period of one year, then a maintenance cycle must be performed.

<sup>3</sup> Warm up time may vary depending on the operating environment and usage

- All specifications refer to A4-size paper of 80 gsm quality.
- The support and availability of the listed specifications and functionalities varies depending on operating systems, applications and network protocols as well as network and system configurations.
- The stated life expectancy of each consumable is based on specific operating conditions such as page coverage for a particular page size (5% coverage of A4).  
The actual life of each consumable will vary depending on use and other printing variables including page coverage, page size, media type, continuous or intermittent printing, ambient temperature and humidity.
- Some of the product illustrations contain optional accessories.
- Specifications and accessories are based on the information available at the time of printing and are subject to change without notice.
- Konica Minolta does not warrant that any specifications mentioned will be error-free.
- All brand and product names may be registered trademarks or trademarks of their respective holders and are hereby acknowledged.



Visit our product page